

GROUND FLOOR PLAN AT +500 LEVEL

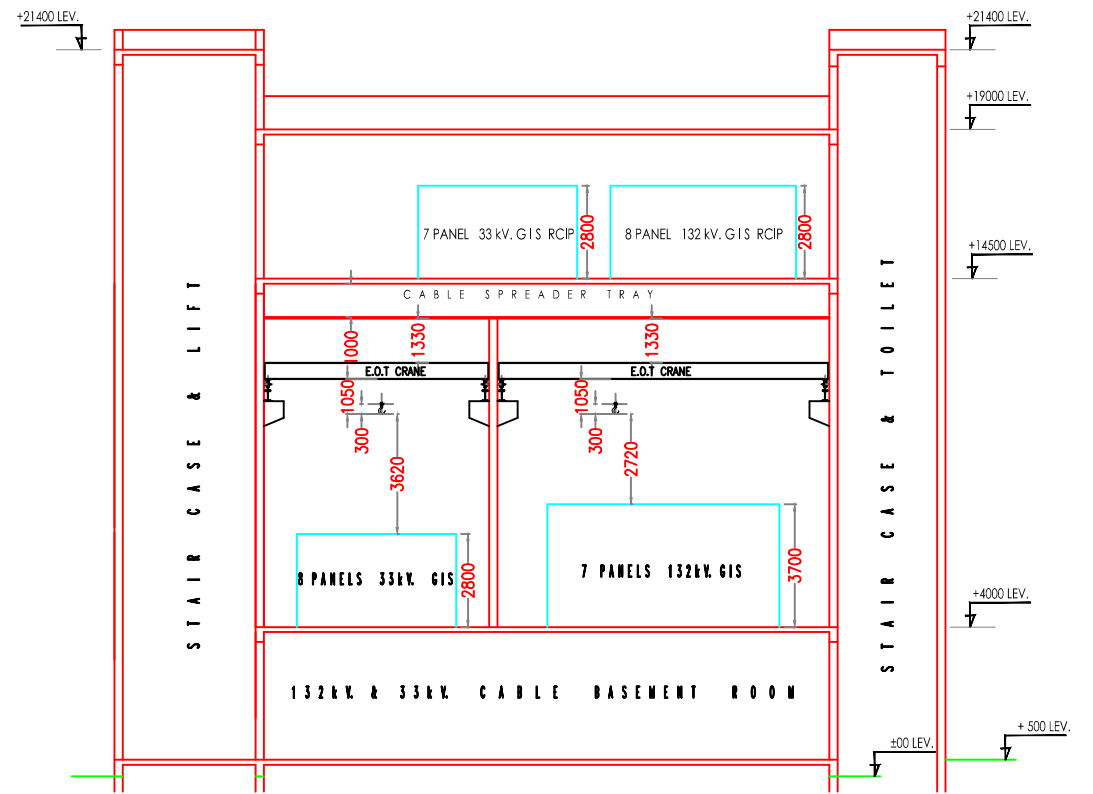

SECTION ON A-A

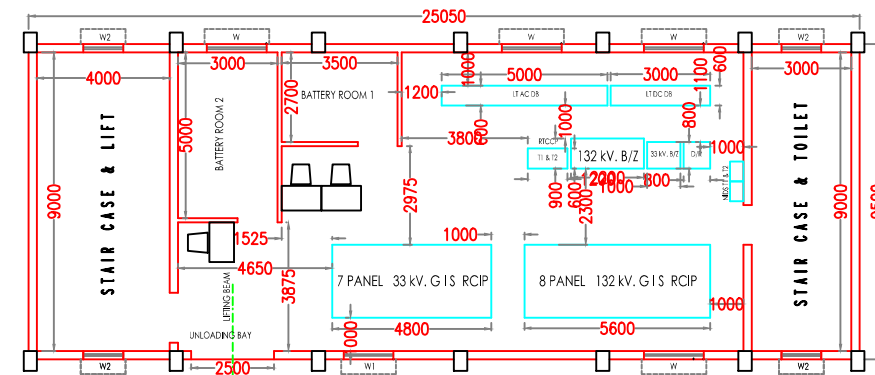

CONTROL ROOM PLAN AT +14500 LEVEL

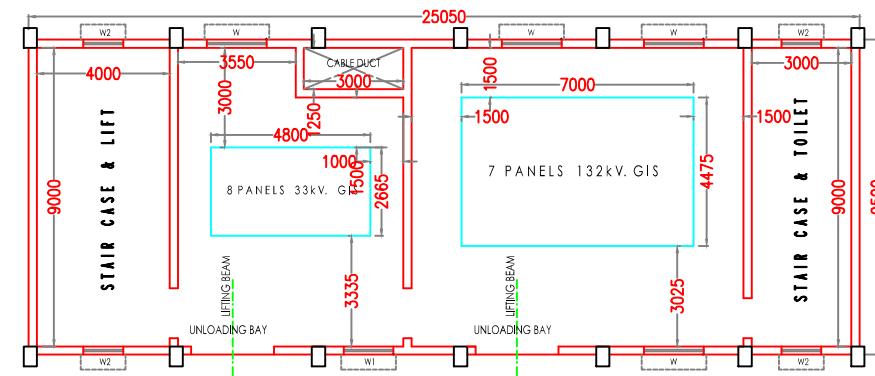

33kV, 132kV, GIS FLOOR PLAN AT +4000 LEVEL

SCHEDULE OF DOORS & WINDOWS		
DOOR -	D	1500 x 2100
	D1	1200 x 2100
	D2	1000 x 2100
	D3	750 x 2100
WINDOWS -	W	1800 x 1350
	W1	1500 x 1350
	W2	1200 x 1350
	W3	600 x 600

NOTE :-

AREA OF LAND = 1217.025 SQM.  
OR 18 KH. - 3 CH. - 5 SFT.

REVIEWED						
APPROVED	REVIEWED	CHECKED	DRAWN	DESCRIPTION	REV.	DATE

Proposed Autonagar 132/33 kV Substation  
Equipment Layout Drawing

DWG. NO : DWG NO : LFA-2013-14



Power Research and Development Consultants Pvt. Ltd.  
#5, 11th Cross, 2nd Stage, WOC Road,  
Bangalore-560 086, INDIA.  
Tel : +91-080-23192159,23192168,  
E-mail : prdc@vsnl.com